



In the weightless state,
the slider is in the top position

The slider moves down due to
the weight of the speaker

Lateral wall
convex blocks
move outwards

The convex block is
not stressed and does
not protrude



SB307SLT Air-cushion Lifting Speaker Stand

Specification:

Height: 1100-1800mm
Load capacity: 50kg
Material: aluminum alloy
Inner box: 135x125x1075mm(1pcs)
Master Carton:
290x270x1100mm(4pcs)

Patent NO.: #201308330689 2013208611907
2019203840568

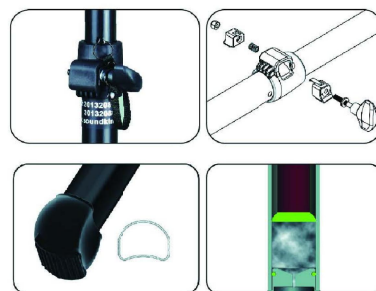

Foot tube section

Air cushion

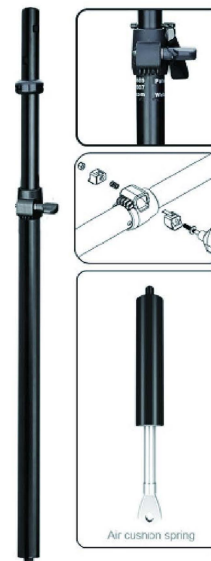

SB311SLT Pneumatic Sub Pole

Specification:

Height: 800-1340mm
Load capacity: 50kg
Material: aluminum alloy
Inner box: 95x75x960mm(1pcs)
Master Carton:
440x365x1015mm(8pcs)



SB313SLT Sub Pole

Specification:

Height: 750-1290mm
Load capacity: 50kg
Inner box: 95x75x770mm(1pcs)
Master Carton:
600x190x825mm(8pcs)

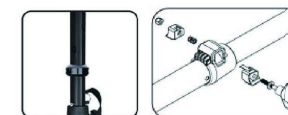

SB400LWSS All-metal, excellent load capacity

The surface adopts high temperature static powder spraying. It is fixed by anti-skid screw, equipped with safety pin and fixed by two adjusting knobs. It has 6 retractable metal support strips.

Specification:

Color: black
Main rod diameter: $\phi 38$
Telescopic rod diameter: $\phi 34.8$
Foot tube diameter: $\phi 34.8$
Tube thickness: 0.8
Height: 1020-1800mm
Load capacity: 100kg
Material: High-quality carbon steel
Inner box: 155*140*1050mm
Master carton: 315*175*1070mm (2pcs)
Weight: 4.8kg





SB075 Sub Pole

This product features a telescopic rod with upper and lower ends (external diameter $\phi 35$) sheathed in anti-shake plastic parts, the lower end (external diameter $\phi 35$) has M20 external thread, capable of interchanging with any product with M20 internal thread, especially suitable to be used with our DC032 product for more stability.

Specification:

Height adjustment range: 810--1350mm

Maximum load: 45kg

Net weight: 1.5kg

Connection: upper end external diameter $\phi 35$ / lower end external diameter $\phi 35$ - external thread M20

Material: steel

Surface treatment: powder coating black matt



DC032

Specification:

Net weight: 0.42 kg

Connection: internal hole $\phi 35$

/internal screw thread M20

Material: iron

Surface treatment: powder-coated black matt

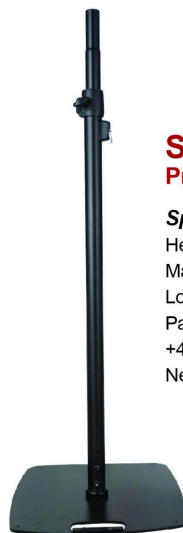

SB318 Pneumatic Lifting Speaker Stands

Specification:

Height: 1100-1800mm

Material: Aluminum+Cold-rolled steel base

Load capacity: 30kg

Package: 290x270x1150mm(6pcs)

+485x60x465(1pcs)

Net weight: 11.5kg

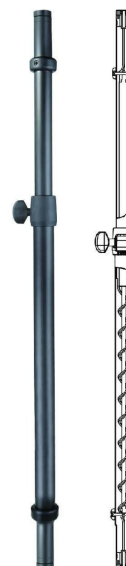

SB310AP Pneumatic Lifting Sub Pole

Internal with telescopic gas spring (stroke: S=450mm pressure: F=130N);

The diameter of the connecting round hole is 35mm.

The product has its own signal cable. The two ends of the pipe are provided with a 6.35 female base, which connects the upper and lower loudspeakers separately. The contacts are reliable and the operation is convenient.

Specification:

Height: 890-1230mm

Load capacity: 50kg

Weight: 1.8kg

Material: aluminum alloy

Inner box: 110X75X920mm

SB800 Pneumatic Lifting Speaker Stands

The surface of pipe fittings is high temperature electrostatic powder spraying, the transfer parts are plastic, equipped with knobs to adjust, Spring pin fixed, built-in 25KG air spring push rod.

Specification:

Color: black

Adjustable height: 1155—1815mm

Load-bearing 60kg

Material: high quality carbon steel

Inner carton: 130*130*1155mm

Outer carton: 280*280*1180mm (4 pcs)

Net weight: 5.4kg

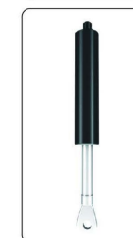
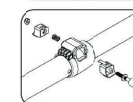

Air cushion spring





DF146 Desktop Studio Monitor Speaker Stand

Specification:
Height: 255-345mm
Material: Steel
Load capacity: 20kg
Estimation of inner box size: 260x85x350mm(1pcs),
Net weight: 2.2kg
Estimation of master carton size: 80x370x380mm(4pcs)
Gross weight: 10.5kg



DF147 Desktop Clamp-On Studio Monitor Speaker Stand

Specification:
Height: 255-345mm
Material: Steel
Load capacity: 20kg
Estimation of inner box size: 260x85x350mm(1pcs),
Net weight: 3.3kg
Estimation of master carton size: 80x370x380mm(4pcs)
Gross weight: 15kg



SB307 Air-cushion Lifting Speaker Stand

Specification:
Height: 1100-1800mm
Load capacity: 50kg
Material: aluminum alloy
Inner box: 135x125x1075mm (1pcs)
Master Carton: 290x270x1100mm (4pcs)

Patent NO.: #2013208330689 2013208611907

Dual-block mechanism holding telescopic tube for reliable operation; without the need of safety pin.
Easy to adjust the height of speaker cabinet;



DF180

Surface adopts high temperature static powder spraying, trolley handrails can fold together, and bearing length is adjustable.

Specification:
Color: black
Using range: 345x(755-1290)mm
Material: steel
Inner box: 900x480x290(1pcs)
Master carton: 915x505x310(1pcs)
Net weight: 15.5kg
Load capacity: 200kg



SB001 Studio Monitor Foam Isolation Pads

The two parts can be used separately or in combination to support the speaker.

Specification:
Color: black
Material: High density sponge
Upper cushion: 300x260x30x15mm
Lower cushion: 330x260x50x35mm
Inner box: 340x270x115mm
Master carton: 565x360x380mm (6pcs)



SB308 Air-cushion Heavy Lifting Speaker Stand

Specification:
Height: 1100-1800mm
Load capacity: 60kg
Material: aluminum alloy
Inner box: 130x130x1070mm (1pcs)
Master Carton: 280x280x1095mm (4pcs)

Patent NO.: #2013208330689 2013208611907

A: Dual-block mechanism holding telescopic tube for reliable operation; without the need of safety pin. Easy to adjust the height of speaker cabinet.
B: Air cushion mechanism to prevent from the speaker cabinet falling quickly and meanwhile ensure the safe operation;

SB309

Pneumatic Lifting Speaker Stands

Specification:

Height: 1100-1800mm

Load capacity: 60kg

Material: aluminum alloy

Inner box: 130x130x1130mm (1pcs)

Master Carton: 280x280x1155mm (4pcs)

Patent NO.: #2013208330689 2013208611907

A: New locking mechanism for reliable safe operation; without the need of safety pin; Easy to adjust the height of the speaker cabinet by one hand.

B: Air cushion spring mechanism to prevent from the speaker cabinet falling quickly and make easy lifting and meanwhile ensure the safe operation;



SB308L

Extra Long Air-cushion Speaker Stands

Specification:

Height: 1320-2200mm

Load capacity: 60kg

Material: aluminum

Inner box: 130x130x1330mm (1pcs)

Master Carton: 280x280x1360mm (4pcs)

Patent NO.: #2013208330689 2013208611907

A: Dual-block mechanism holding telescopic tube for reliable operation; without the need of safety pin. Easy to adjust the height of speaker cabinet.

B: Air cushion mechanism to prevent from the speaker cabinet falling quickly and meanwhile ensure the safe operation;

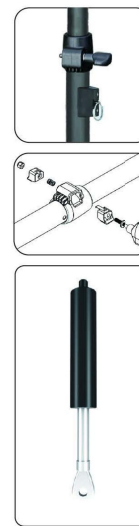

SB310

SB310/SB311

Pneumatic Sub Pole

Specification:

Height: 800-1340mm

Load capacity: 50kg

Material: aluminum

Inner box: 95x75x860mm (1pcs)

Master Carton: 440x365x915mm (8pcs)

Patent NO.: #2013208330689



SB311



SB312

Sub Pole

Specification:

Height: 860-1260mm

Load capacity: 50kg

Material: steel

Inner box: 95x75x860mm (1pcs)

Master Carton: 600x190x915mm (10pcs)

Patent NO.: #2013208330689

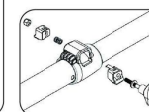

SB313

Sub Pole

Specification:

Height: 880-1300mm

Load capacity: 50kg

Material: steel

Inner box: 95x75x770mm (1pcs)

Master Carton: 600x190x825mm (10pcs)

Patent NO.: #2013208330689

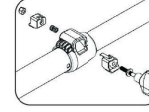



SB400

Height	1100-1680mm
Material	steel
Inner box	130x120x970mm (1pcs)
Master Carton	380x280x995mm (6pcs)
Weight	3.5kg (inner box/1pcs)



SB401

Height	1100-1680mm
Material	aluminum
Inner box	125x125x1150mm (1pcs)
Master Carton	400x270x1175mm (6pcs)
Weight	3kg (inner box/1pcs)



DB009B/W

Height	1000-1800mm
Load Capacity	50kg
Material	Aluminum
Inner box	130x120x1060mm(1pcs)
Master Carton	380x280x1090mm(6pcs)
Weight	2.5kg(inner box/1pcs)

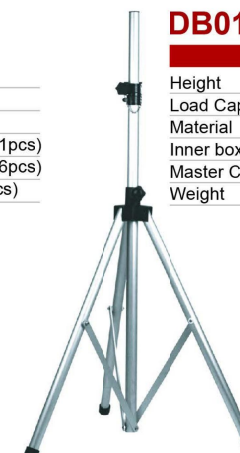

DB012B/W

Height	1000-1800mm
Load Capacity	50kg
Material	Aluminum
Inner box	130x120x1060mm(1pcs)
Master Carton	380x280x1090mm(6pcs)
Weight	2.5kg(inner box/1pcs)



SB500
Speaker Stand

All designed with rivet connection, no screw, not falling

Specification:

Height: 1040-1720mm
Load capacity: 45kg
Material: Steel
Inner box: 130x120x970mm (1pcs)
Master Carton: 380x280x995mm (6pcs)
Weight: 3.8kg (1pcs)

Patent NO.: #2013208330689 2013208611907

Dual-block mechanism holding telescopic tube for reliable operation; without the need of safety pin. Easy to adjust the height of speaker cabinet.

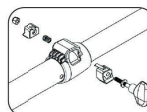

Crank-up speaker stand

DB019B

Height	1480-2420mm
Load Capacity	80kg
Material	Steel
Inner box	170x140x1530mm(1pcs)
Master Carton	300x190x1550mm(2pcs)
Weight	10kg(inner box/1pcs)



Air-cushion speaker stand

DB035B

Height	1080-1800mm
Load Capacity	60kg
Material	Aluminum
Inner box	140x130x1100mm(1pcs)
Master Carton	300x280x1130mm(4pcs)
Weight	3.7kg(inner box/1pcs)



This speaker stand utilizes compress air principle. It can protect the speaker from sudden drop when not secure properly.



DB088B/S

Adjust Height	1100-2010mm
Load Capacity	60kg
Weight	3kg
Material	Aluminum & Steel
Inner box	130×130×1190mm(1pcs)
Master Carton	1210×280×415mm(6pcs)

DB089B/S

Adjust Height	1025-2440mm
Load Capacity	50kg
Weight	2.5kg
Material	Aluminum & Steel
Inner box	130×120×1060mm(1pcs)
Master Carton	380×280×1100mm(6pcs)



DB021B/W

Height	1000-2000mm
Load Capacity	60kg
Material	Aluminum
Inner box	140x130x1100mm(1pcs)
Master Carton	300x280x1120mm(6pcs)
Weight	3kg(Inner box / 1pcs)



DB023B

Height	800-1340mm
Load Capacity	50kg
Material	Steel
Inner box	100x60x810mm(1pcs)
Master Carton	320x220x830mm(10pcs)
Weight	1.5kg(Inner box/1pcs)



DB039B

Height	690-1300mm
Plate size	230x230mm
Base(WxD)	450x450x450mm
Material	Steel
Inner box	850x500x60x70mm(1pcs)
Master Carton	600x160x880mm(4pcs)
Weight	5kg(Inner box / 1pcs)

SPEAKER STANDS



DB075

Sub Pole

Screw Thread: M20
Max. Weight capacity: 80kg
Shipping Package: 22x32x78cm(10pcs)



DB078

Wall Mount Speaker Bracket

Load Capacity	40kg
Material	steel
Inner box	155x110x620mm(1pcs)
Master Carton	350x330x650mm(6pcs)
Weight	3kg(Inner box/1pcs)

DC016

Speaker Mount

Screw Thread: M20
Hole Pitch: $\Phi 82$ mm
Shipping Package: 57x46x18cm(100pcs)



DB081

Crank up Subwoofer Pole

Height	800-1100mm
Load Capacity	60kg
Material	Steel
Inner box	170X62X790mm(1pcs)
Master Carton	190X145X810mm(2pcs)
Weight	3kg(Inner box/1pcs)



DB087

Wall Mount Speaker Bracket

Load Capacity	30kg
Inner box	270x85x400mm
Master Carton	360x295x430mm(6pcs)
Weight	2kg



DC001

I.D: 35mm
Material: Plastic
Master Carton:
460x400x280mm (50pcs)



DC002

I.D: 25mm
Material: Plastic
Master Carton:
460x400x280mm(100pcs)



DC004

I.D: 35mm
Height: 90mm
Material: Metal
Master Carton:
460x400x280mm(100pcs)



DC005

I.D: 25mm
Height: 85mm
Material: Metal
Master Carton:
420x220x300mm(100pcs)



DC006

I.D: 35mm
Height: 90mm
Material: Plastic
Master Carton:
460x400x280mm (100pcs)



DC007

I.D: 35mm
Height: 97mm
Material: Metal
Master Carton:
460x400x280mm(100pcs)



DC008 DC009

I.D: 35mm(DC008)
I.D: 38mm(DC009)
Material: Steel
Master Carton:
420x220x300mm(25pcs)
Weight: 0.19kg



DC010

I.D: 35mm
O.D: 38x100mm
Material: Plastic
Master Carton:
460x400x280mm(200pcs)
Weight: 0.14kg



DC011

I.D: 25mm
O.D: 35x80mm
Material: Plastic
Master Carton:
460x240x280mm(200pcs)
Weight: 0.11kg

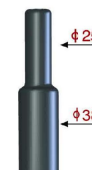

DC012

I.D: 25mm
O.D: 35x80mm
Material: Metal
Master Carton:
420x220x300mm(50pcs)

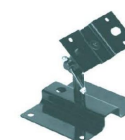

DB010

Load Capacity: 18kg
Weight: 0.7kg
Material: Steel
Shipping Package:
120x105x105mm(1pcs)
Master Carton:
540x250x220mm(20pcs)
Weight: 1kg



DB011

Load Capacity: 18kg
Weight: 0.7kg
Material: Steel
Shipping Package:
120x105x105mm(1pcs)
Master Carton:
540x250x220mm(20pcs)
Weight: 1kg



DB038

Height: 150mm
Plate Size: 60x310mm
Material: Steel
Shipping Package:
320x160x70mm(1pcs)
Master Carton:
340x340x70mm(10pcs)
Weight: 1kg

SPEAKER STANDS